

P-732

CRIMPING TOOL



Non-slip comfortable fitting feeling of elastomer handle grips with reduce a fatigue of operators.

- Heavy duty ratchet action crimp tool with a toggle mechanism for prolonged use.
- This crimp tool with a toggle mechanism can clamp to a non-insulated terminal by one-handed operation lightly easily.

- Applicable terminals:1.25/2.0
- O.A.L.:180mm
- Weight:270g

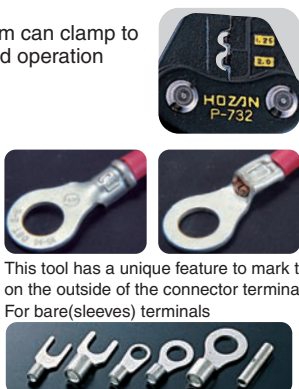
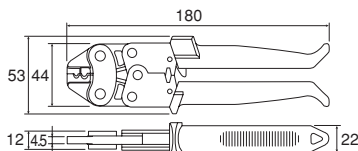

This tool has a unique feature to mark the size on the outside of the connector terminal For bare(sleeves) terminals



JIS C9711 CONFORMITY

CRIMP COMPLETION MECH.

ELASTOMER GRIPS

CUTTERS
WIRE STRIPPERS
CRIMPERS

TWEEZERS
WRENCHES

SCREWDRIVERS & METAL WORKING TOOLS

CASES & BAGS

TOOL KITS

SOLDERING TOOLS

DESOLDERING TOOLS

MEASURING INSTRUMENTS

MICROSCOPES & STATIC CONTROL

CLEAN ENVIRONMENT

CHEMICALS

MAINTENANCE TOOLS

MAINTENANCE TOOLS

P-722

CRIMPING TOOL



The toggling mechanism requires only a light touch.

- Furthermore this crimper also includes a wire stripper and cutter so it is an all-in-one tool for crimping work.

- Applicable terminals:1.25/2.0
- O.A.L.:180mm
- Weight:275g

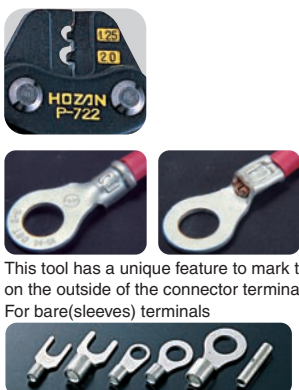
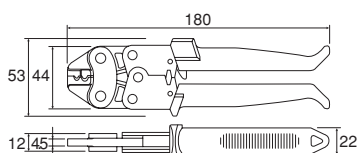

This tool has a unique feature to mark the size on the outside of the connector terminal For bare(sleeves) terminals

Cutter and wire stripper function



ELASTOMER GRIPS

P-733

CRIMPING TOOL



This crimp tool with a toggle mechanism can clamp to a insulated terminal by one-handed operation lightly easily. And ratchet action ensures connection terminations.

- Heavy duty ratchet crimp action ensures repeatable and reliable connection terminations.

- Applicable terminals:0.3/0.5/1.25/2
- O.A.L.:204mm
- Weight:350g

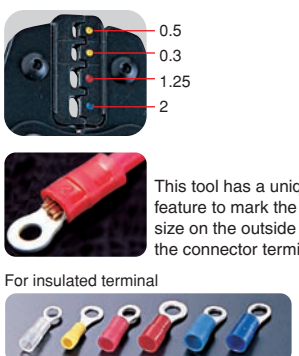
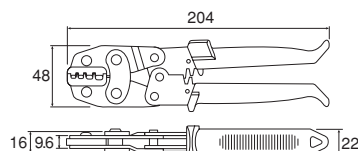

This tool has a unique feature to mark the size on the outside of the connector terminal

For insulated terminal

Terminal of 0.5

Terminal of 0.3

※ Terminal 0.3 is large than terminal 0.5.

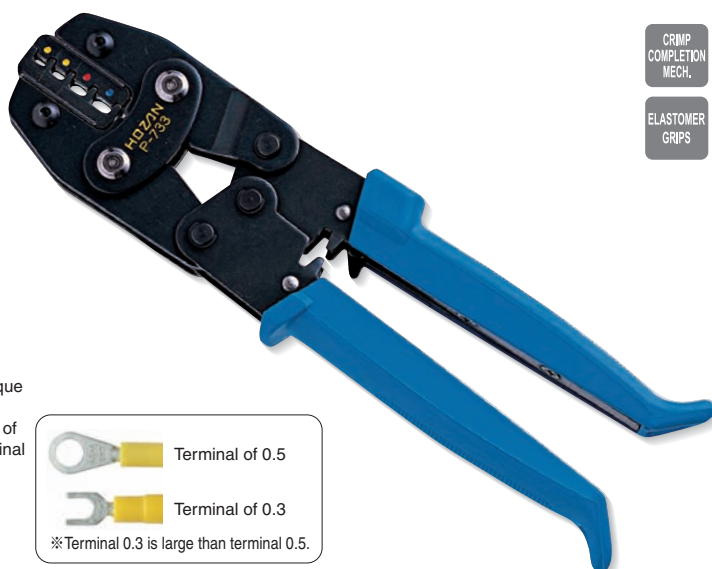

CRIMP COMPLETION MECH.

ELASTOMER GRIPS

JIS C9711について

JIS C9711は屋内配線用電線接続工具の規格です。その接続工具の概要は、ダイスの硬さがHRC38以上であり、ダイス間が適正な圧着接続ができる距離に達しなければ接続端子を工具から取り外すことができない成形確認機構がなければなりません。また使用ダイスが端子に表示されるようダイス部に刻印があります。圧着後の引っ張り試験は使用電線が1.25mm²の場合200N(20.4kgf)、2.0mm²の場合290N(29.6kgf)、5.5mm²の場合780N(79.5kgf)、8mm²の場合980N(100kgf)の引張荷重値を10秒間加えて線切れ・線抜けがないよう決められています。

圧着工具点検マニュアル無料

当社の圧着工具のJIS認定品においては、JISに基づいた性能試験を実施し、ご要望により試験成績表を発行(有料)しております。(P-77は点検表のみ)また、お客様において日常的に点検できる点検マニュアルを、無料でご用意しておりますのでご利用ください。この点検はダイスの摩耗具合をクリンプハイトゲージで確認するもので、非常に簡易かつ有効な方法ですのでお勧めいたします。

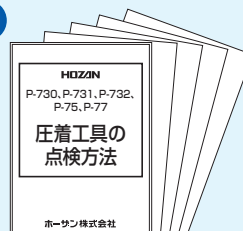

Replacement Parts

P-732-6 SPRING

- For P-732/733/736/740
- 1 pair spring per pack

