

# KEL 24

## Cable entry frames



1

### Product description

The KEL-24 matches exactly the cut-out dimensions of 24-pole standard industrial connectors.

The split insert matching the cable diameter is placed around the cable and inserted into the cable entry frame.

Either a cut out of 36mm or 46mm tall can be chosen depending on the cables being routed. This flexibility is perfect for pre-terminated cables.

### Advantages

- Warranty of pre-terminated cables remains
- Retrofitting and maintenance can be carried out easily and quickly
- High packing density, wide variety of frames and inserts
- Strain relief according DIN EN 50262

### Specification

Material	Polyamide
Flame class	UL-94 Vo, self-extinguishing
Protection class	IP 54, with gasket and correct selection of the cable inserts
Temperature	- 40°C to + 140°C (static)
Properties	halogen-free, silicone-free
Cut-out dimensions	36 x 112 mm / page 94

### Accessories

KT Cable inserts	Page 22   26
KEL-SNAP SNAP frames	Page 15
KEL-EMC Cable collector	Page 74   75
KDR2   KDR Base plates	Page 80   83
FP Flanged plates	Page 84   85
MP Module plates	Page 86

#### Description

#### Type

#### Order No.

#### Inserts KT small | large

#### PU

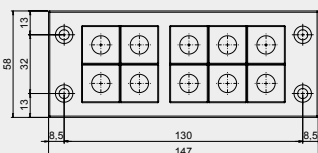

KEL  
24 | 10

42241

10 | -

10

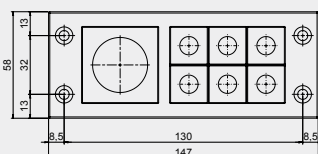

KEL  
24 | 7

42247

6 | 1

10



KEL  
24 | 5

42248

5 | -

10

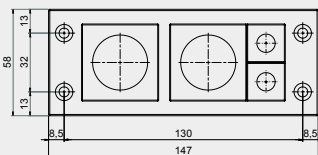

KEL  
24 | 4

42244

2 | 2

10