

PIN #	COLOR
1	BROWN
2	WHITE
3	BLUE
4	BLACK
5	GRAY

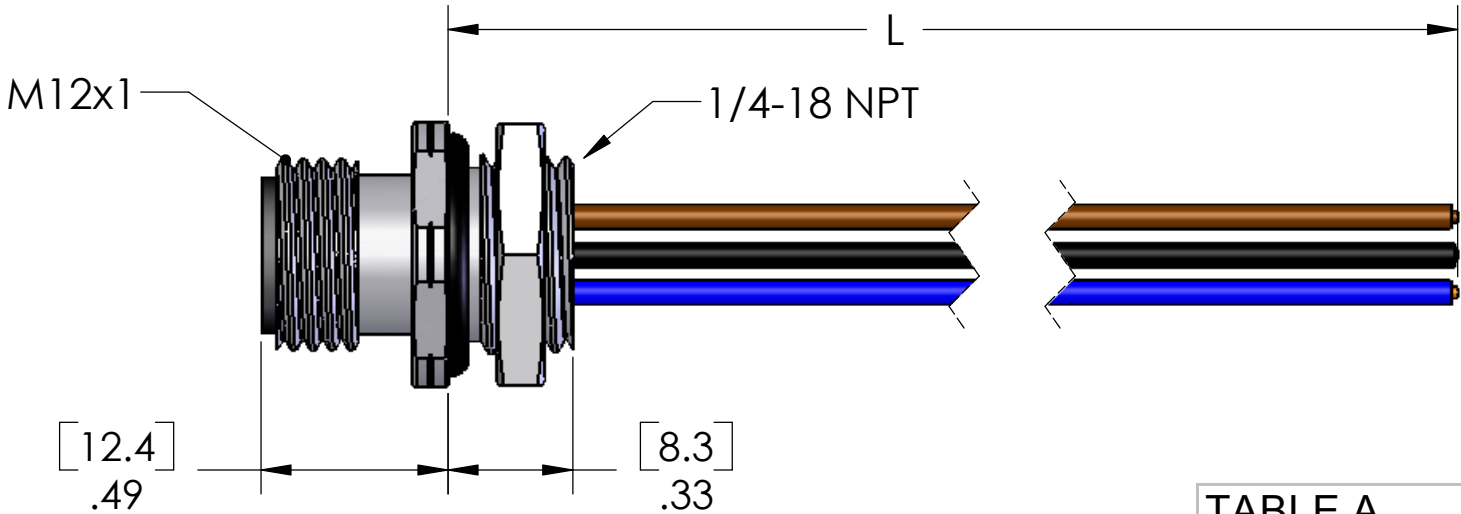
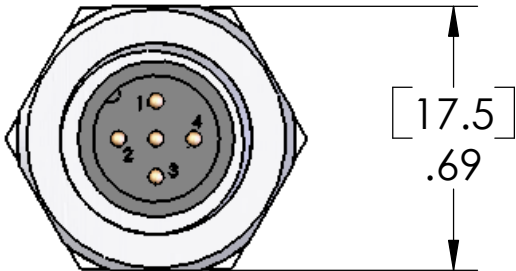

TABLE A		
P/N	L	STD?
MDC-5MR-4-0.15M	6"	NO
MDC-5MR-4	12"	YES
MDC-5MR-4-0.5M	20"	NO
MDC-5MR-4-1M	39"	YES
MDC-5MR-4-2M	79"	YES
MDC-5MR-4-5M	197"	NO
MDC-5MR-4-10M	393"	NO

MATERIALS	
BODY:	NICKEL PLATED BRASS
CONTACTS:	GOLD PLATED BRASS
WIRE:	22AWG UL1007
INSERT:	POLYAMIDE
O-RING:	BUNA-N
NUT:	ZINC PLATED STEEL

APPROVALS	
U.S.	UL RECOGNIZED
CANADA	C-UL RECOGNIZED

PROPRIETARY AND CONFIDENTIAL  
THE INFORMATION CONTAINED IN THIS  
DRAWING IS THE SOLE PROPERTY OF  
MENCOM CORPORATION. ANY  
REPRODUCTION IN PART OR AS A WHOLE  
WITHOUT THE WRITTEN PERMISSION OF  
MENCOM CORPORATION IS  
PROHIBITED.

VOLTS	300V
AMPS	4A
TEMP	105°C

SPECIFICATIONS DO NOT SCALE DRAWING

UNLESS OTHERWISE SPECIFIED:  DIMENSIONS ARE IN INCHES AND [MM]		NAME	MENCOM CORPORATION
	DRAWN	BEM	
	CHECKED		
	ENG APPR.		
	MFG APPR.		
MATERIAL	COMMENTS:		TITLE:
FINISH			
DO NOT SCALE DRAWING			

SIZE	DWG. NO.	REV
B	MDC-5MR-4-ZZ	A
SCALE: 2:1	WEIGHT:	SHEET 1 OF 1

PARTS LISTED AS NOT BEING STANDARD MAY  
HAVE MINIMUM ORDER QUANTITIES